



35,000 square feet
For Sale

2400-2410 Manning Two 17,500 sq ft Light Industrial Buildings

Site located on Manning Street near two Business 80 on ramps: El Camino and Arden Way

Perimeter is fenced with hard metal fencing with roll gates

Buildings include 9,000 square feet of office area and 8,500 square feet of additional gravel fenced area



Contact: Herb Liverett or Jim Holmes

Herb Liverett Companies, Inc.

1100 N Street, Suite 1-C, Sacramento, CA 95814

www.callherb.com

Email: liverettco@sbcglobal.net

916.451.9011

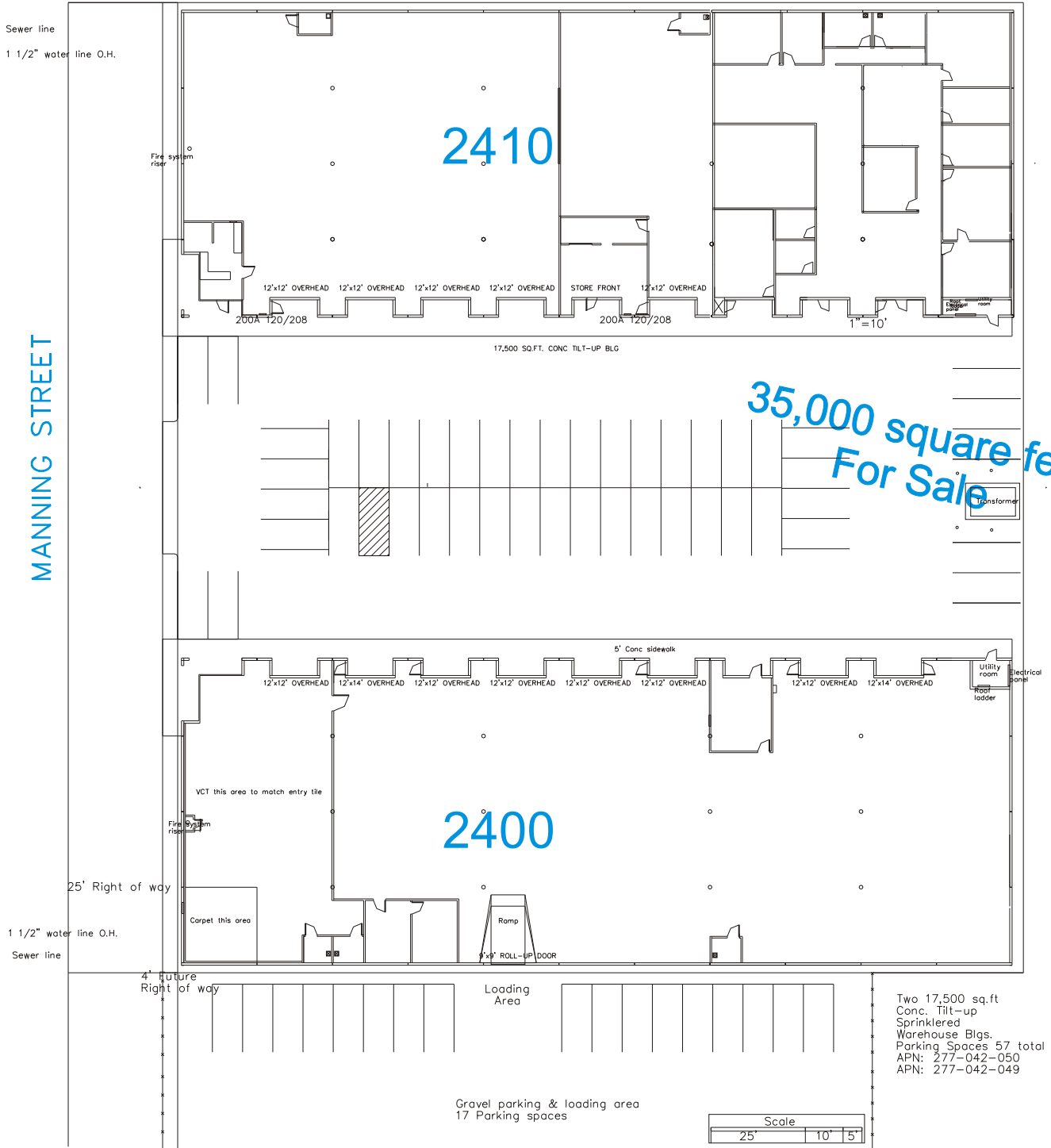

35,000 square feet For Sale

MANNING STREET

2410

2400

Two 17,500 sq.ft
 Conc. Tilt-up
 Sprinklered
 Warehouse Bldgs.
 Parking Spaces 57 total
 APN: 277-042-050
 APN: 277-042-049

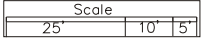

Contact: Herb Liverett or Jim Holmes

Herb Liverett Companies, Inc.

1100 N Street, Suite 1-C, Sacramento, CA 95814

Email: liverettco@sbcglobal.net

916.451.9011

The above information while not guaranteed, has been secured from sources we deem reliable. However no warranty or representation, express or implied, is made as to the accuracy of the information contained herein. All information should be verified by the recipient prior to purchase or execution of legal documents.