

Herb Liverett Companies, Inc.  
1817 Maryal Drive, Suite 300  
Sacramento, CA 95864  
916.485.5575 / 916.485.6788 FAX  
www.callherb.com



## 2400 Manning Street

One of two 17,500 square foot concrete tilt-up industrial buildings

Great location situated off  
Business 80 Between El Camino  
and Arden Way

For Lease

2400 - 2410  
Manning Street  
Sacramento, CA

Leasing  
From 3,200 to 17,500 sqft

The site is completely fenced  
with wrought iron fencing

Contact:  
Herb Liverett 916.869.8017  
Susan Slayton 916.397.9806  
Jim Holmes 916.952.5298

Aggressive  
Lease  
Concessions  
to  
Qualified Tenants

The above information while not guaranteed, has been secured from sources we deem reliable. However, no warranty or representation, express or implied, is made as to the accuracy of the information contained herein. All information should be verified by the recipient prior to purchase or execution of legal documents.

Herb Liverett Companies, Inc.  
 1817 Maryal Drive, Suite 300  
 Sacramento, CA 95864  
 916.485.5575 / 916.485.6788 FAX  
 www.callherb.com

For Lease

2400 - 2410  
 Manning Street  
 Sacramento, CA

## Site Plan

Leasing  
 From 3,200 to 17,500 sqft

The site is completely fenced  
 with wrought iron fencing

Contact:  
 Herb Liverett 916.869.8017  
 Susan Slayton 916.397.9806  
 Jim Holmes 916.952.5298

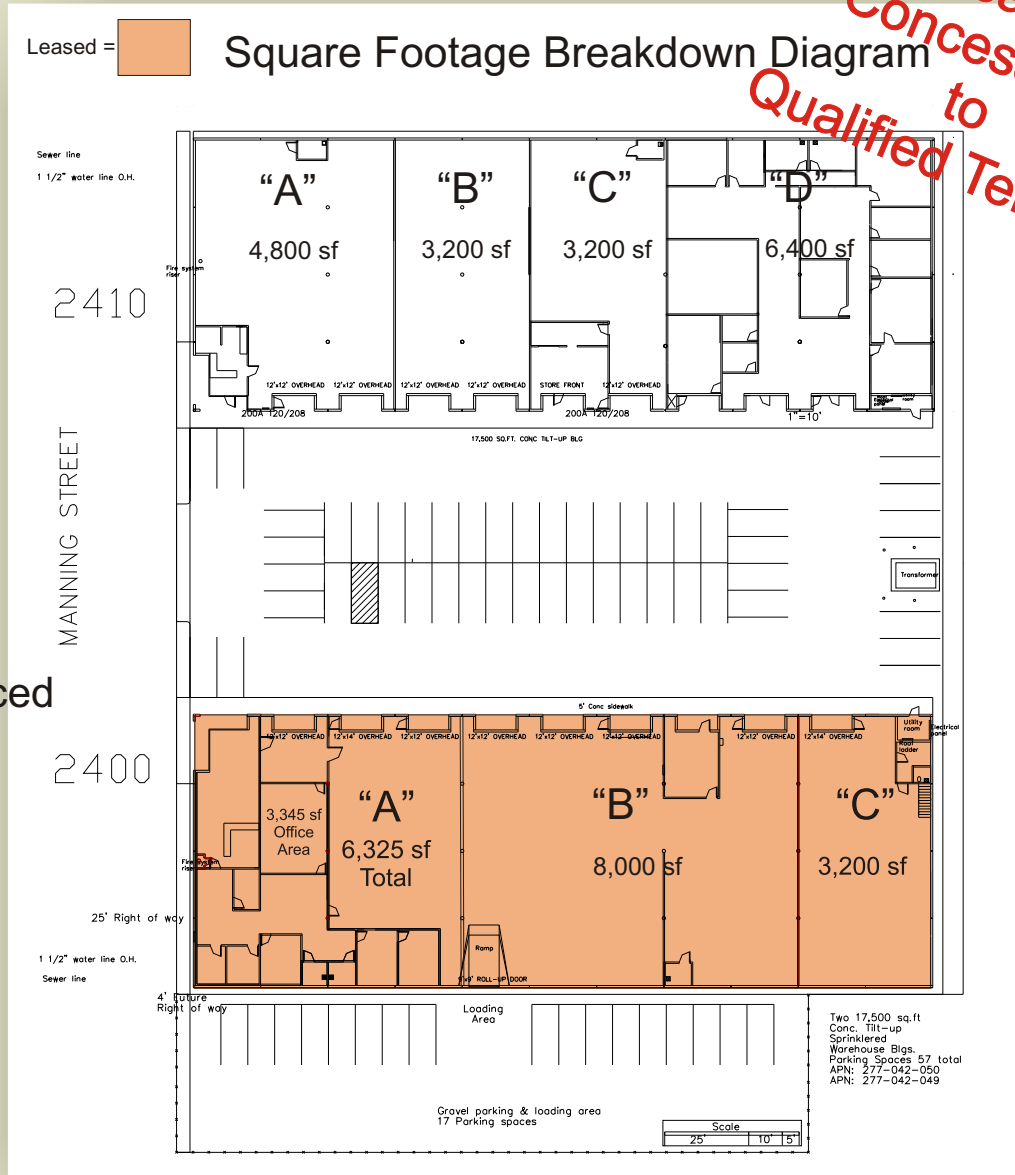

Aggressive  
 Lease  
 Concessions  
 to  
 Qualified Tenants

The above information while not guaranteed, has been secured from sources we deem reliable. However, no warranty or representation, express or implied, is made as to the accuracy of the information contained herein. All information should be verified by the recipient prior to purchase or execution of legal documents.

# For Sale or Lease

## 2400 - 2410 Manning Street Sacramento, CA

**Aggressive  
Lease  
Concessions  
to  
Qualified Tenants**

Herb Liverett Companies, Inc.  
1817 Maryal Drive, Suite 300  
Sacramento, CA 95864  
916.485.5575 / 916.485.6788 FAX  
www.callherb.com

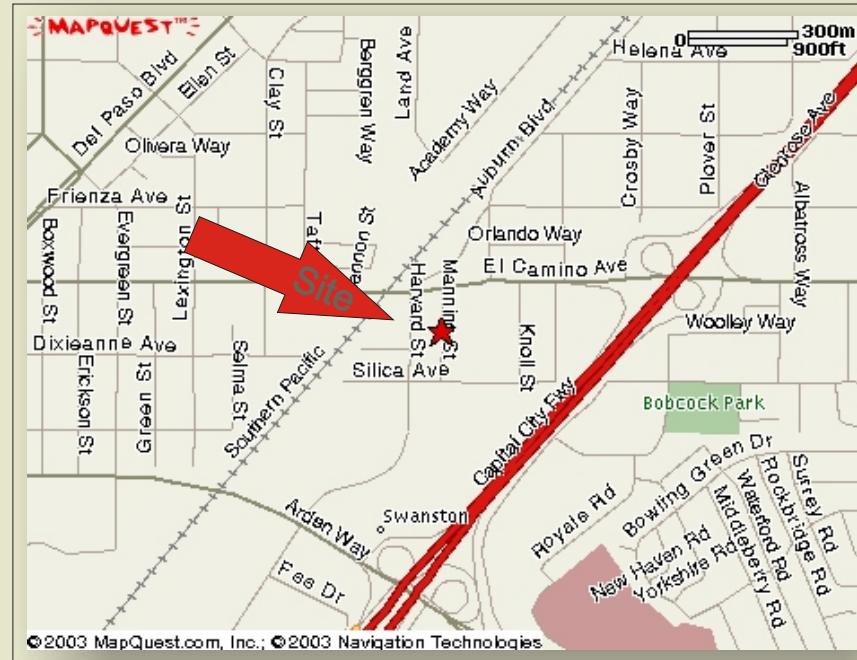

Contact:  
Herb Liverett 916.869.8017  
Susan Slayton 916.397.9806  
Jim Holmes 916.952.5298

The above information while not guaranteed, has been secured from sources we deem reliable. However, no warranty or representation, express or implied, is made as to the accuracy of the information contained herein. All information should be verified by the recipient prior to purchase or execution of legal documents.